

Seattle Shutter Specification

1. Components:

Frame:

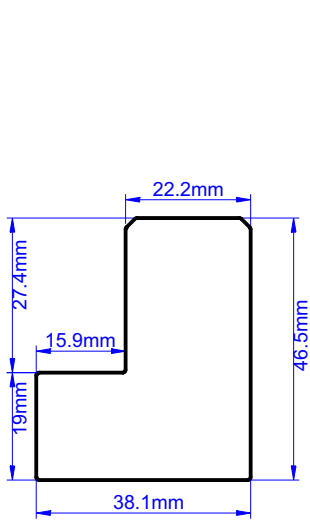

46.5mm Chamfer L Frame

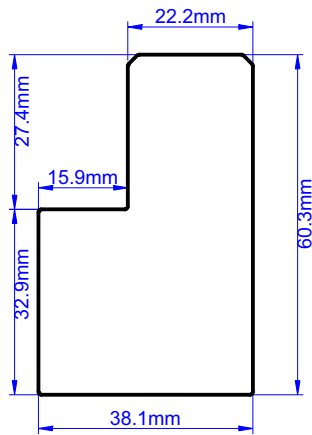

60.3mm Chamfer L Frame

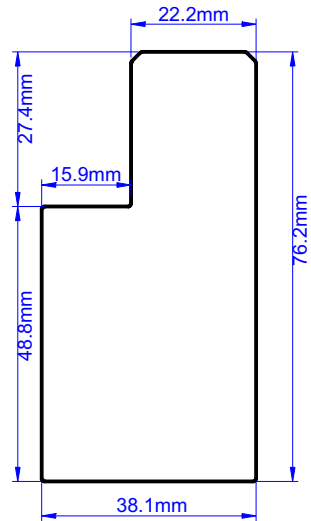

76.2mm Chamfer L Frame

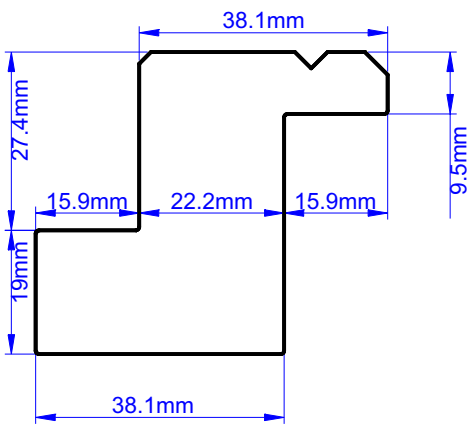

38.1mm Serrate Z frame

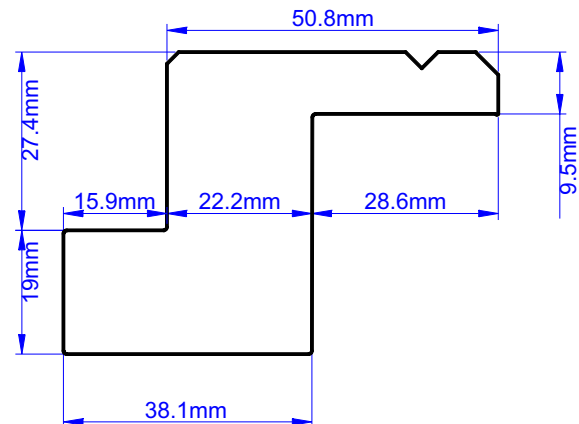

50.8mm Serrate Z frame

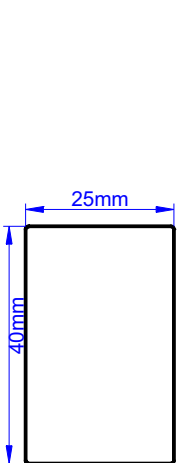

40mm Hang strip

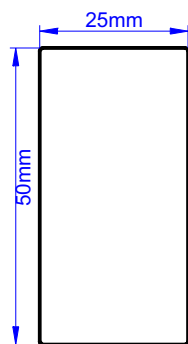

50mm Hang strip

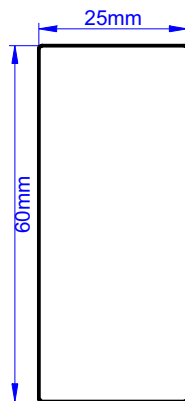

60mm Hang strip

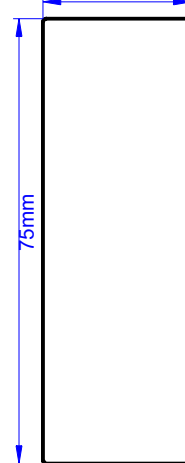

75mm Hang strip

Seattle Shutter Specification

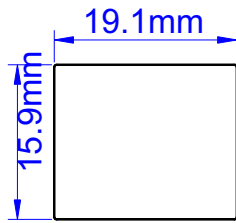

Light Block

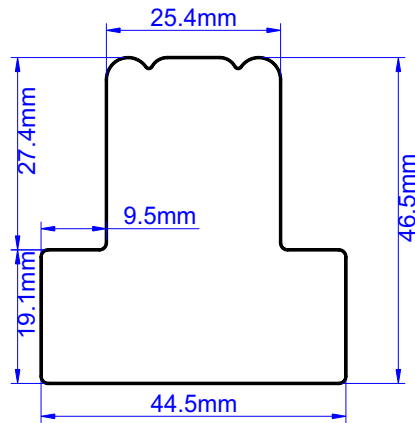

25.4mm T-post

Stile:

Butt Stile (41.3mm & 50.8mm): Usually used on the side of panel that is hinged to batten or frame.

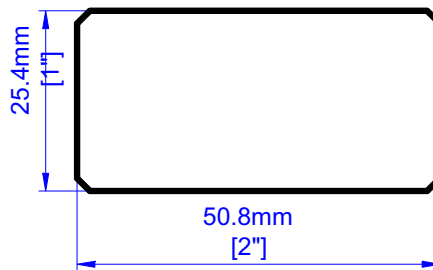
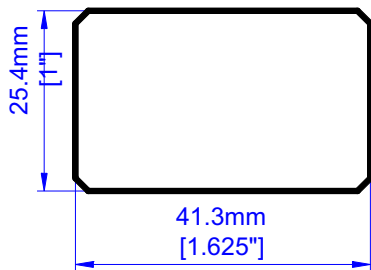

Rabbit Stile (41.3mm & 50.8mm): Used on bi-fold panels or where 2 panels meet.

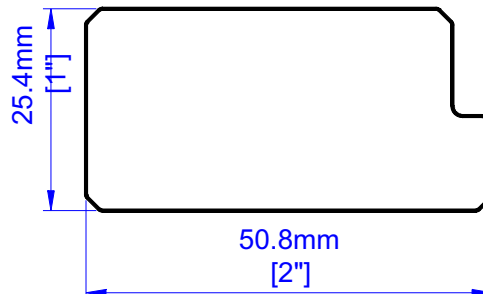
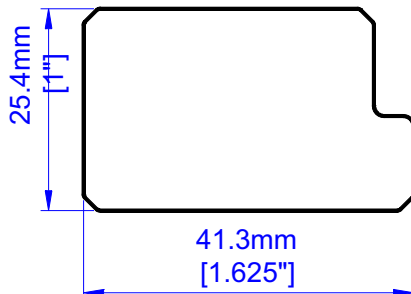

Astragal Stile (41.3mm & 50.8mm): used when 2 panels meet.

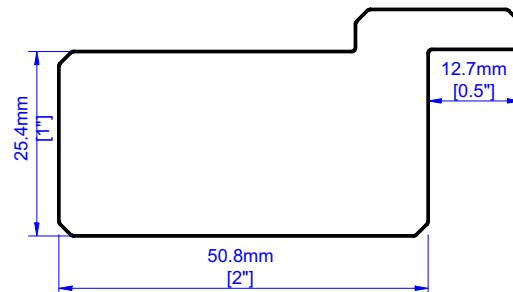
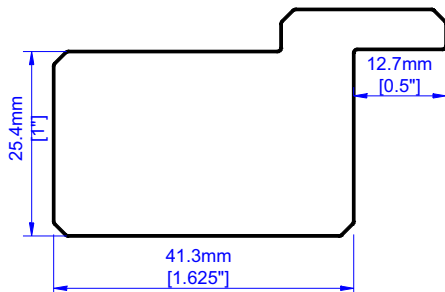

Rails:

Top & bottom rail: Usually the Top & Bottom rail will be larger than 80mm, Factory will decide the size, unless otherwise specified. The top and bottom rail will be the similar size if there is no divider rail. If you need different size rails, please specify. We suggest ordering shutters for the same order at one time, so that the rail size will match.

Seattle Shutter Specification

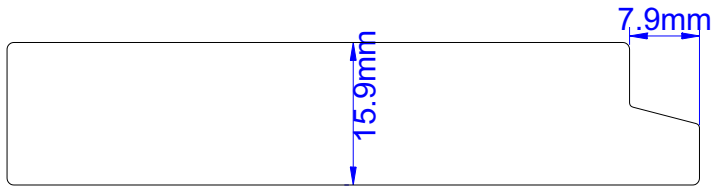

Divider rail: Standard divider rail is 76.2mm. If panel height is over 1800mm, a divider rail is required. If you do not specify the divider rail location, we will hold the order to confirm whether you require the divider rail or not. But if specify no divider rail, we will regard it as you have waived your warranty. Divider rail location may be off by half a louver:

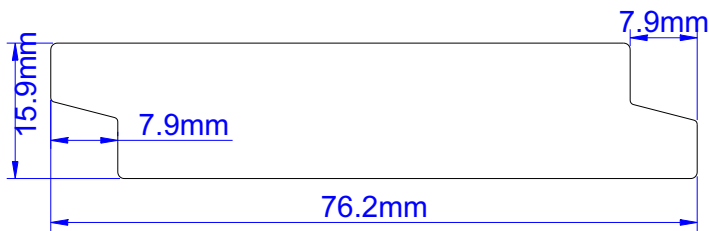

Louvers:

47mm louver

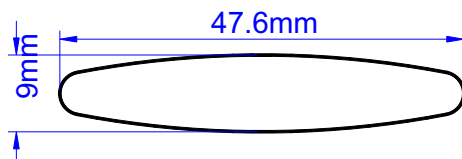

64mm louver

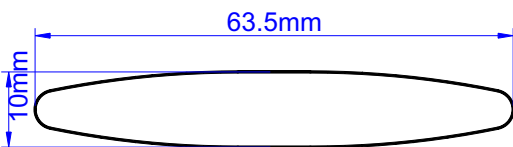

89mm louver

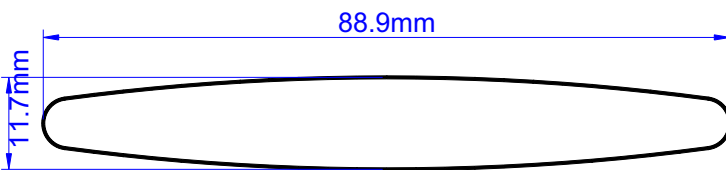

114.3mm Louver

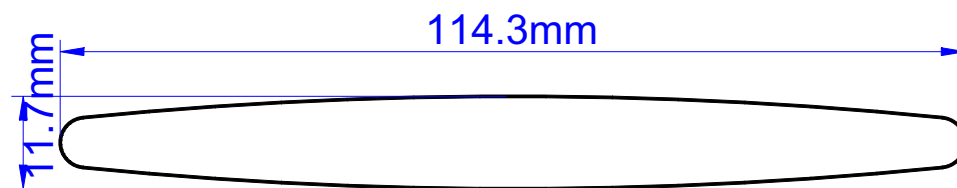

Tilt rod:

1) Standard Tilt Rod:

Seattle Shutter Specification

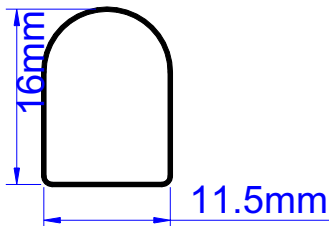

2). **Hidden tilt rod:** Notch out the louvers, only available for 63.5mm, 88.9mm and 114mm louvers, not available for 47mm louver. Hidden Tilt Rod colors please refer to the Color Option.

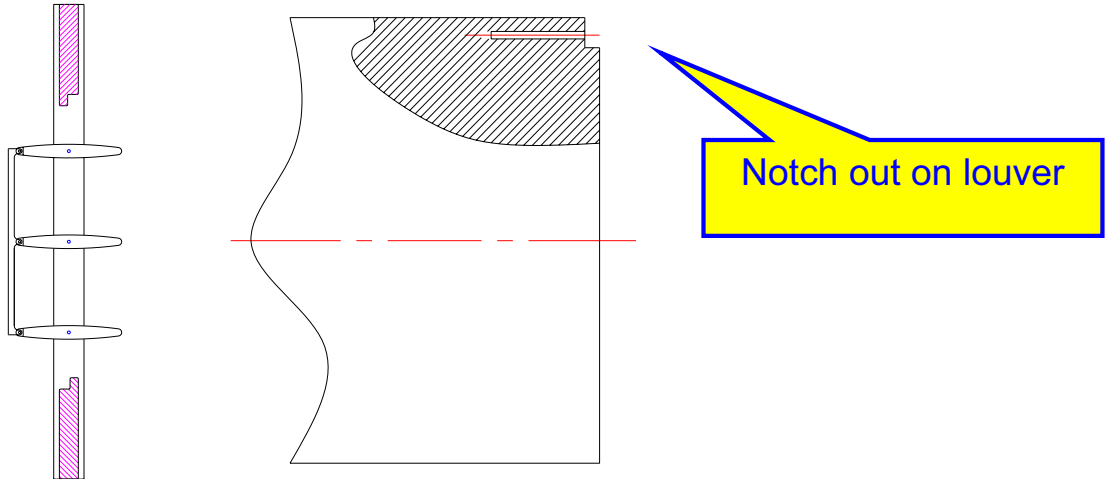

3) **Offset Tilt Rod:** Tilt rod can be ordered offset from center. Please specify the position from the center of the tilt rod to the end of the louver. The standard distance for the offset tilt rod is 25mm to the end of the louver on hinge side.

*** Tilt rod position for multi-fold shutters:

For the multi-fold panels, we will make the tilt rod offset from the center. By doing so, panels can be folded flat without tilt rods being obstructed with each other. The standard offset for the tilt rod is 7mm from the center, i.e. tilt rod will be 7mm to the left from the center for the left panels, and 7mm to the right from the center for the right panels. The rabet is made with right panels over left ones for the both the panels folded to left and to right.

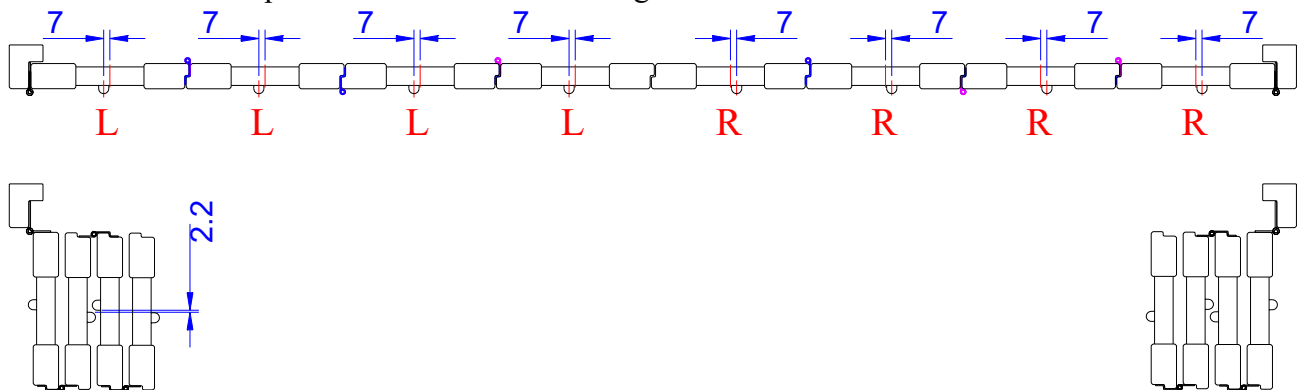

For the 2 panels and 4 panels configuration (LLRR), tilt rod in center of panel, no need to offset.

Louver Pin:

Louver pins are used to ensure louver tension. Additionally a tension rod is inserted through a louver in the panel. This will require the panel to have holes in the stiles for the screw caps of the

Seattle Shutter Specification

tension rod. The tension can be adjusted by tightening or loosening the screw caps.

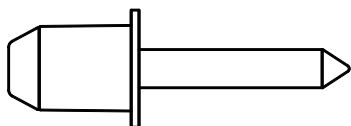

3. Color Options:

Shutter Color		Default Hidden Tilt Rod Color	Hinge Color	
			Default Color	Optional Color
Solid Color	003 Silk white	White	White	1. Bright Brass 2. Antique Brass 3. Stainless Steel (Surcharge)
	006 Pearl	Pearl	Pearl	
	013 Bisque	Bisque	Bisque	

Please order shutters for the same home at one time. Slight variations may also occur between the finished products and the color decks.

4. Panel size limitation:

Louver size	Width			Height	
	Min.	Max		Min.	Max
		Single Hung	Bi-fold or multi-fold		
47mm	152mm	750mm	550mm	250mm	3000mm
63mm	152mm	750mm	550mm	250mm	3000mm
89mm	152mm	750mm	550mm	250mm	3000mm
114mm	152mm	750mm	550mm	250mm	3000mm

If panel size exceeds the limitation above, warranty is void.

5. Panel configuration:

Rabbit Stile: if choose rabbit stile on the order form, then the panels will be made like the following drawings.

1 Panel: L or R

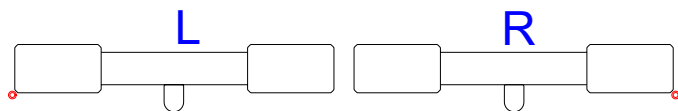

2 Panels: LL/RR/LR

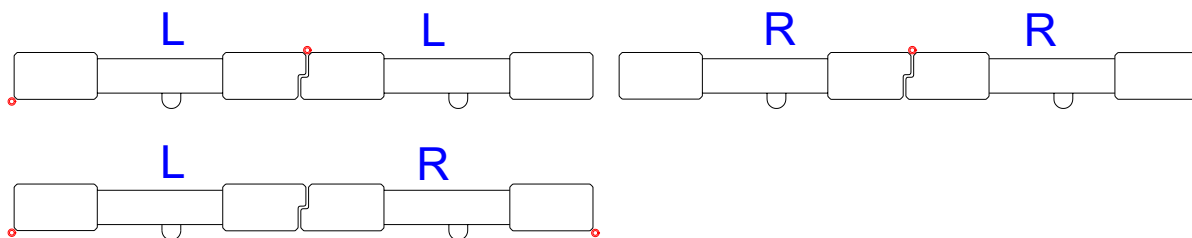

3 Panels: LLR/LRR

Seattle Shutter Specification

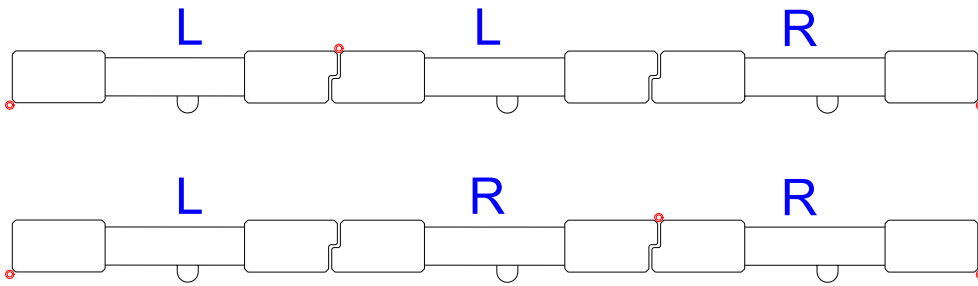

4 Panels: LLRR

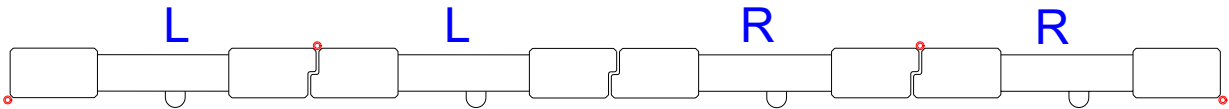

Astragal Stile: If choose astragal stile in the order form, then panels will be made like the following drawings.

1 Panel L or R: (both side to be butt stile)

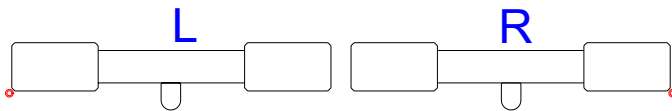

2 Panels:

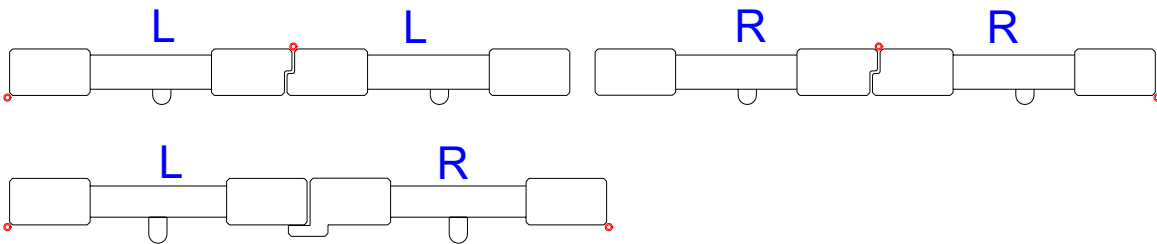

3 panels:

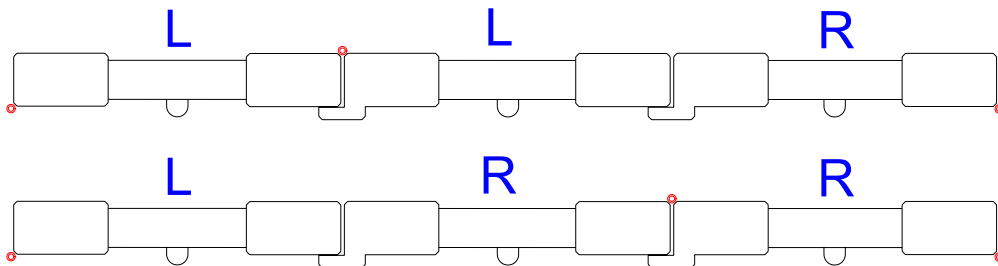

4 panels:

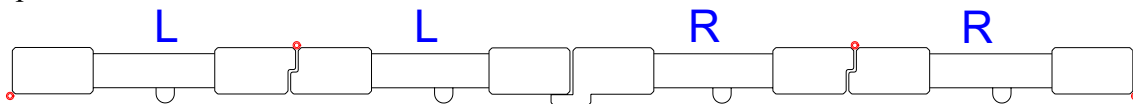

6 panels or more: will be made like the following, astragal stile is only used where 2 panels meet without hinges.



Please specify the panel fold configuration on order form, we will pre-hinge according to it.

Seattle Shutter Specification

We do not suggest making the panels with multi-fold. Only bi-fold is under warranty. Because the composite wood shutter is too heavy, heavy panels have more trends to sag. If you require a multi-fold configuration please order it in wood.

6. Tolerance:

Width: The width of the panel can be plus or minus 1mm from the order width.

Height: The height of the panels can be plus or minus 1.6mm from the order height.

Divider rail location: Divider rail location may be off by half a louver:

For 47mm louver can be off by +/-19mm.

For 63mm louver can be off by +/-25mm.

For 89mm louver can be off by +/-38mm.

For 114mm louver can be off by +/-51mm.

7. Hardware:

Hinges: 3 types: Self-Mortise Hinge, Rabbet Hinge and Astragal bi-fold hinge. The hinge colors please refer to the Color Option.

Self-Mortise Hinge (marked with “M”): used between the panel and frame (or battens).

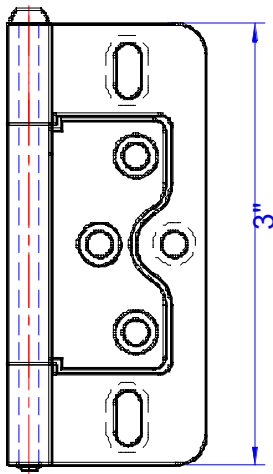

Rabbet Hinge (marked with “N”): used between the panels. (Hinge pin is removable)



Seattle Shutter Specification

MDF astragal bi-fold hinge (marked with "B"): used between butt stile and astragal stile, such as 3 panels configurations with astragal stiles.

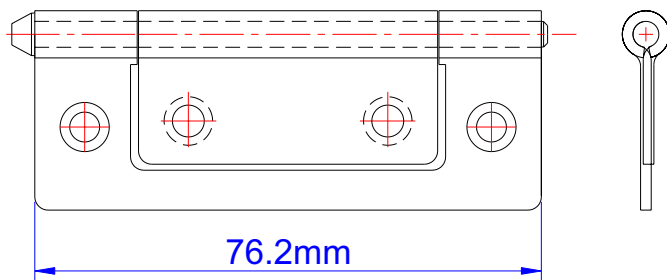

All hinges will be pre-mounted on panels.

Panel height/ Hinge amount:

Panel height	No. of hinges
<=1219mm	2
1219mm~1981mm	3
1981mm~2438mm	4
2438mm~3048mm	5
>3048	6

Magnets & Magnet catches

Plastic Magnets: Magnets will be included in hardware box.



Round Magnet & Magnet Catches: Will be supplied when order "OD of frame size", will be pre-mounted on panels.

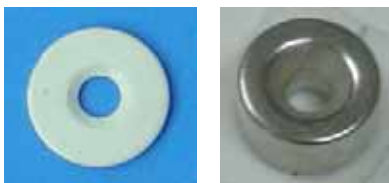

Panel Foot: will be supplied when order panel with frame.



Hoffmann Key: for joining frames together. Will be supplied for each of frame corner.



Seattle Shutter Specification

CustomWest starts manufacture of Seattle products mostly within 1 hour of the order being placed. Once in manufacture is not possible to pull the order from the floor. Nor is it possible to change the colour or specification after ordering. Hinge colour maybe changed at fitting time only. This will normally be a chargeable service, discuss with your dealer.